

BUCKET ELEVATORS

ETM

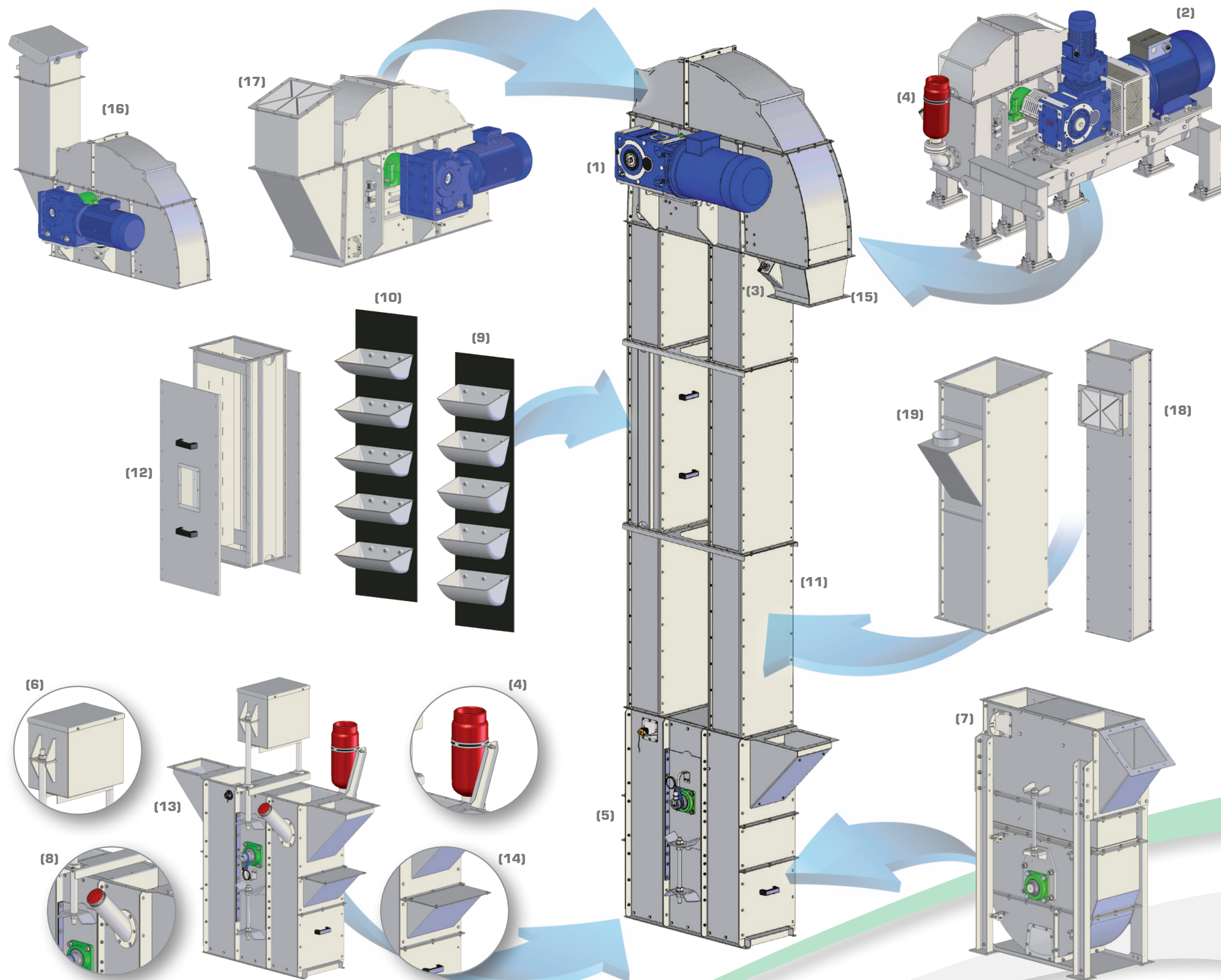

GENERAL CHARACTERISTICS

- Design for the vertical transport of granular or dusty products (typically cereals, oilseeds, flour, meals and their by-products).
- Wide range of machines. Customization according to the customer's requirements.
- Structure with high resistance to over pressure ($\geq 2,0$ bar).
- Surface treatment by hot dip galvanization or epoxidic dust painting.
- Standard execution (CE) or in compliance with ATEX Directive 94/9/CE (Z=22).

Drive head

- Drive unit direct coupled to the shaft. (1)
- Drive head with motor, reducer and joints, complete with support. (2)
- Anti-clogging system at the discharging hopper. (3)
- Belt alignment control system.
- Smooth or rubber coated pulley.
- Upper cover dismountable (one or two pieces).
- Set of anti-wearing sheets interchangeable, in special steel or Rhinohyde.
- Kit for explosion suppression system. (4)

Tail

- Smooth or squirrel cage pulley.
- Standard tensioning system by screws. (5)
- Tensioning system by counterweight. (6)
- Dust tight tail (for application with dusty products).
- Self cleaning tail. (7)
- Speed monitoring system.
- Belt alignment control system.
- Sensor for explosion suppression system. (8)

Buckets and belts

- Buckets for granular products. (9)
- Buckets for dusty products. (10)
- Buckets in pressed steel or in plastic material: polyethylene, polyamide, polyurethane.
- Different type of belt: anti-abrasive, oil resistant, flame retardant, food quality.

Casing

- Standard casing. (11)
- Inspection casing. (12)

Accessories

- Extra inlet hopper. (13)
- Hopper for product recovering. (14)
- Discharging hopper with square outlet. (15)
- Over pressure discharge system with chimney. (16)
- Explosion venting panel on head. (17)
- Explosion venting panel on casing. (18)
- Aspiration connection on casing. (19)

BUCKET ELEVATORS ETM



SERIES		ETM 300		ETM 400				ETM 500			ETM 630		ETM 800	ETM 1000	ETM 1200
MODELS		80	120	140	180	200	230	260	300	330	370	2-330	3-370		
t/h (*)		20	40	60	80	100	120	150	200	250	350	600	1000		
A	mm	930		1326			1500		1885		2190	2365	2589		
A1	mm	696		1023			1052		1365		1594	1896	2279		
A2	mm	345		476			643		860		1010	1454	1918		
B	mm	827		1160			1414		1762		2075	2261	2518		
B1	mm	715		1000			1250		1600		1905	2000	2150		
B2	mm	352		425			535		695		799	1294	1614		
C	mm					1400					2000	2400			
D (**)	mm					400/900/1400/1900/2400/2900									
E	mm	165		250			335		450		500	868	1302		
F	mm	145		230			269		340		350	340	340		
X	mm	165		250			335		450		500	600	600		
Y	mm	250		400			400		500		600	868	1302		
X1	mm	165		250			300		350		500	500	550		
Y1	mm	145		250			300		350		500	868	1302		

(*) Capacity based on wheat - bulk density: weight 0.78 t/m3 - moisture: 15%.
(**) Standard length - special dimensions available upon request.
Our Technical Dept. is available to study special applications.

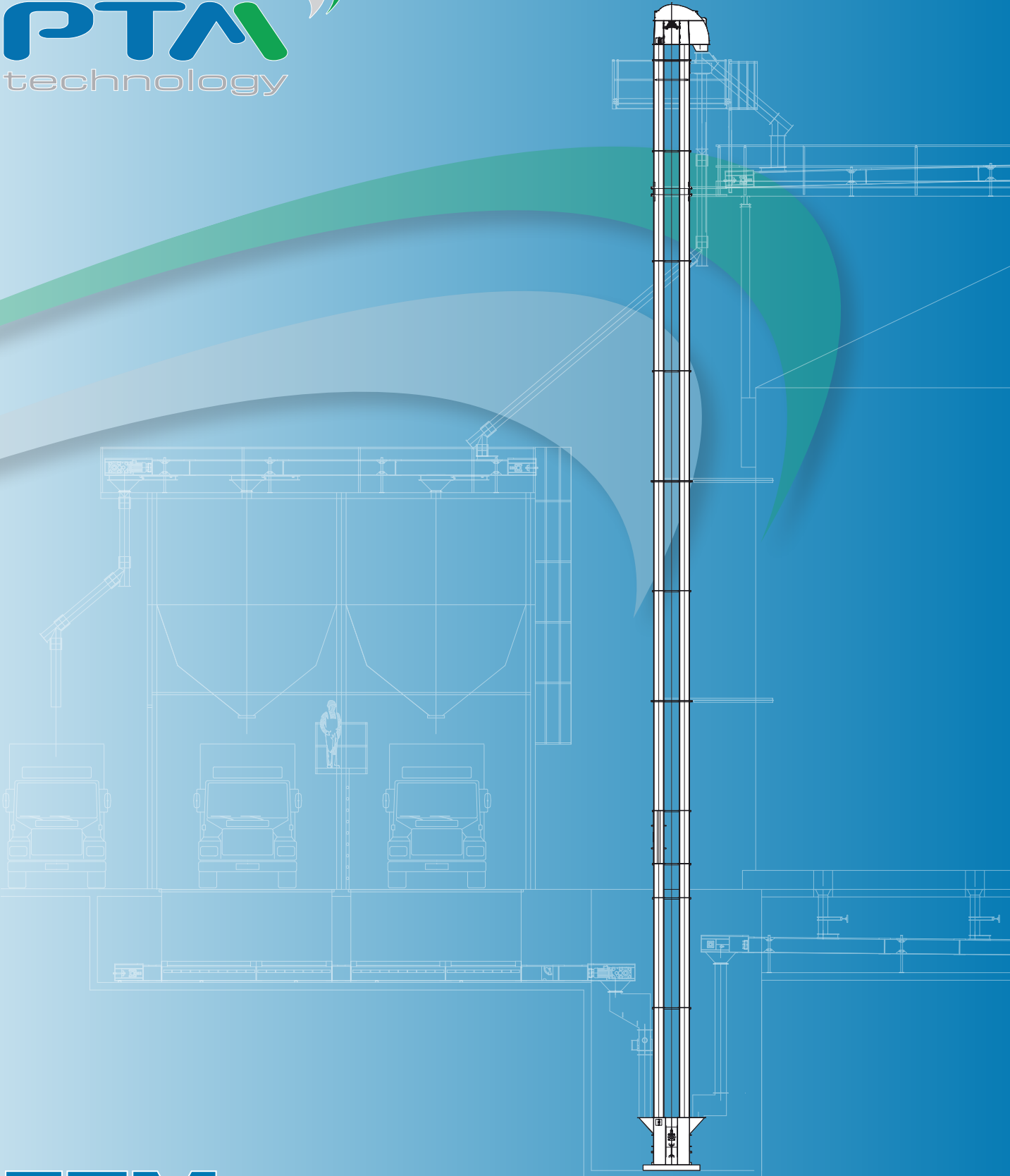
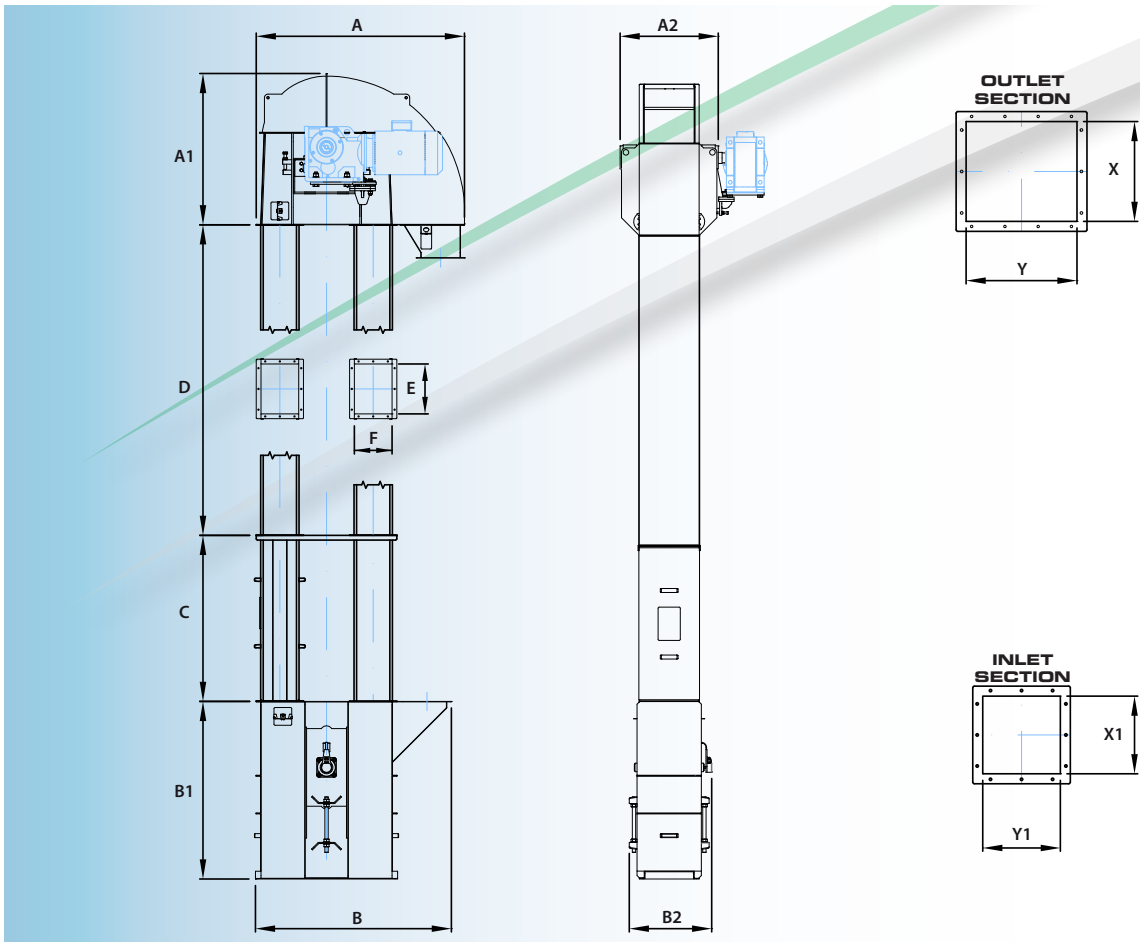

P.T.M. s.r.l. - s.u.
Via Mario Tognato, 10 - 35042 ESTE (PD) ITALY
Tel. +39 0429 600973 - Fax +39 0429 600874
www.ptmtechnology.com - info@ptmtechnology.com

ETM
BUCKET ELEVATORS